



NEOCOLORI

*Colori dell'Italia*



*Stucco Veneziano*

SPECIFICATIONS AND FIELDS OF EMPLOYMENT

**Stucco Veneziano** is natural decorative paste produced according to old Venetian formulas. With stucco veneziano you can replicate typical Venetian marble style. Stucco Veneziano becomes fully washable three weeks after application. It is non-toxic VOC (0) L/A 200g/l (2010). **Application:** It must be used in system with **NEOPRO primer S** and **Cera Garde** wax.

**Thinner:** Ready to use

**Drying time:** touch dry 2 hours, 6 to 8 between coats

**Yield:** 1.2 to 1.5m<sup>2</sup> per 1kg

**Flammability:** Not flammable

**S46** If swallowed, immediately contact a doctor and show him the packaging and labeling

**Date:** Marked on the packaging

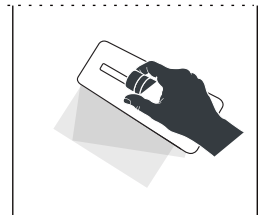

### COMPOSITION

Long-seasoning slaked lime, high-selected calcareous filler, and non-toxic additives.

### METHODS OF APPLICATION

#### *Surface preparation*

The application on lime supports is recommended, but it can also be applied on plaster or by-products, old hydro paints, only if strong and well-fixed, after the application of a coat of **NEOPRO primer S**.

#### **Application**

Spread a coat of Stucco Veneziano with a stainless steel smoother so as to level the support; if needed, spread a second coat. Apply little spots of product and then take them away ("put and remove" technique); when the product is going to dry up, press and move to polish, until the desired result is obtained.

**Coloring of the product:** each color in our color chart has been divided into 4 different shades of Stucco Veneziano.

---

**TECHNICAL DATA**

**Specific weight:** 1,550 kg/lit +/- 3%

**Viscosity:** thixotropic

**Drying:** 2 hours at 20°C

**Complete drying:** 24 hours at 20°C, ready to apply **Cera Garde** after 7 days

**Temperature of application:** between 10°C and 30°C

**Colors:** to be chosen in the catalogue

**Yield:** 1.2 to 1.5m<sup>2</sup> per 1kg

**Package:** 14 lit or 5 lit in polyethylene containers

**Preservation:** 24 months in the intact packages, away from temperature changes

---